

Addendum

There is a typing error on page 6 of the quick start guide. Please refer to this addendum for correct content.

Step 1. Install the CPU

☑ **Mark your CPU Frequency:** Record the working frequency of your CPU, it should be clearly marked on the CPU cover.

<input type="checkbox"/> 300MHz (66 x 4.5)	<input type="checkbox"/> 333MHz (66 x 5.0)	<input type="checkbox"/> 366MHz (66 x 5.5)
<input type="checkbox"/> 400MHz (66 x 6.0)	<input type="checkbox"/> 433MHz (66 x 6.5)	<input type="checkbox"/>

CPU Mount Procedure: To mount the Celeron™ processor that you have purchased separately, follow these instructions.

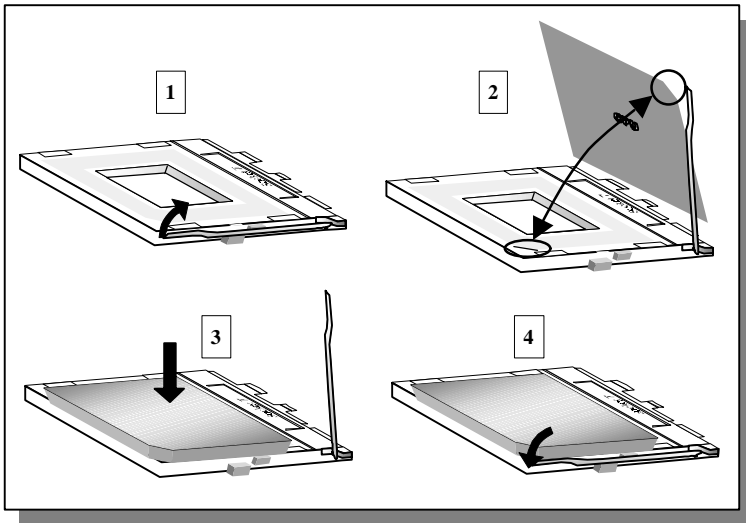

1. Lift the socket handle up to a vertical position.
2. Align the blunt edge of the CPU with the matching edge on the socket.
3. Seat the processor in the socket completely and without forcing it in.
4. Then close the socket handle to secure the CPU in place.



Remember to connect the CPU Cooling Fan to the appropriate power connector on the Motherboard. The fan is a key component that will ensure system stability. The fan prevents overheating, therefore prolonging the life of your CPU.
