

***Enlight***

**SERIES EN-7230**

**USER MANUAL**





## SPECIFICATIONS

MODEL NO:	<b>EN-7230*</b>
CASE SIZE:	<b>ATX-MID-TOWER</b>
MAIN BOARD SIZE:	<b>AT ATX</b>
DRIVE BAYS:	<b>4 * 5.25" HALF HEIGHT 2 * 3.5" / 1" HEIGHT 1 * 3.5" / 1" HIDDEN</b>
EXPANSION SLOTS:	<b>6 FULL SIZE 1 HALF SIZE</b>
POWER SUPPLY:	<b>PS/2 ATX 200W~300W ATX 12V 340W</b>
DIMENSIONS:	<b>W195*H425*D480 MM (W7.7"*H16.7"*D18.9")</b>
WEIGHT(G.W):	<b>28 LBS. (INCLUDING POWER SUPPLY)</b>
CHASSIS:	<b>0.8 MM THICK SECC GALVANIZED JIS STEEL</b>
FRONT BEZEL:	<b>UL CLASS-94HB</b>

## STEP 1. REMOVE FRONT BEZEL

Fig. 1

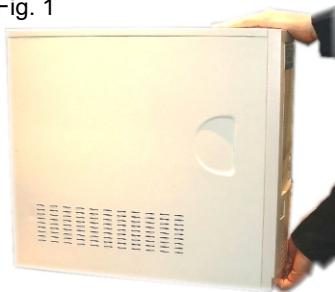

With one hand holding top of chassis, pull in quick motion from the bottom of the bezel to remove it (Fig. 1,2,3).

Be careful not to pull bezel off before hinges are disengaged.

### NOTE

It might require some force to remove due to the snag fit to the chassis.

Fig. 2

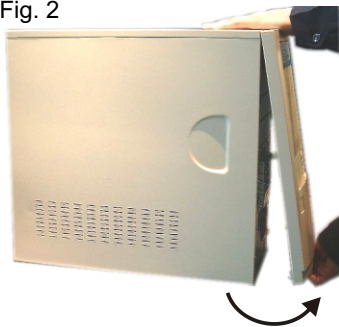
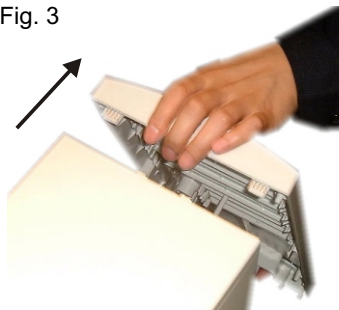
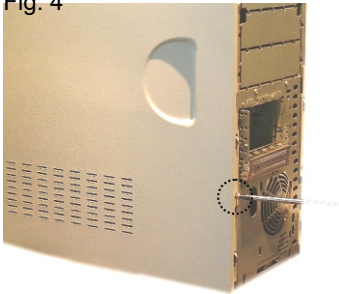

Fig. 3



## STEP 2. REMOVE LEFT SIDE PANEL

Fig. 4



Remove screw.(Fig:4)

Fig. 5

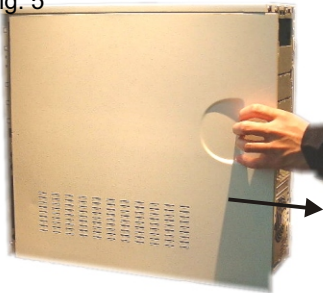

Slide left side panel towards you 1" and lift up.(Fig:5,6)

Fig. 6

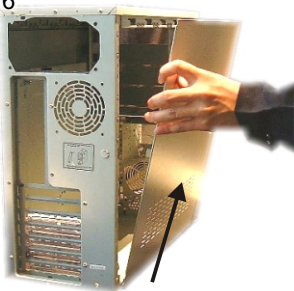

### STEP 3. INSTALL THE POWER SUPPLY



Slide into P/S area and fasten with hex head screws.(Fig:7,8)

Fig. 8



## STEP 4. INSTALL MOTHERBOARD (M/B)

Fig. 9

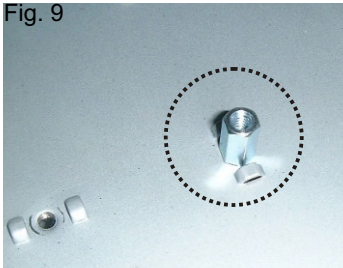

**A.** Using your choice of standoffs (Fig.9) or stakes (Fig.10) to fasten M/B, prepare and screw into mounting plate.

**B.** Make sure punch out holes for I/O ports on the I/O plate are punched out matching ports on the M/B.

Fig. 10

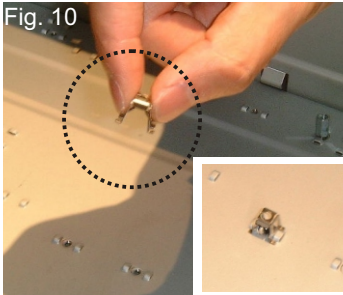

**C.** Install M/B at an angle, first by lining up the I/O ports on the M/B with I/O plate.

Fig. 11



**D.** Once holes are lined up, set M/B on standoffs or stakes and make sure the M/B is seated properly. (Fig.11)  
(M/B mounting screw holes vary with manufacturer. Please refer to M/B user manual for details.)

Fig. 12

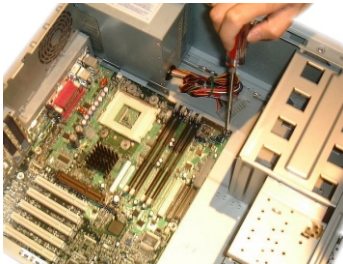

**E.** Fasten M/B using hex head screws. (Fig.12)

**F.** Connect wiring as directed in M/B user Manual.



## STEP 5. INSTALL CD-ROM , 5.25" FDD , DVD

Fig. 13



Fasten slide guides to the side of CD-ROM ( DVD or 5.25" FDD) Using fine thread flat head screws (Fig 13).

Fig. 14

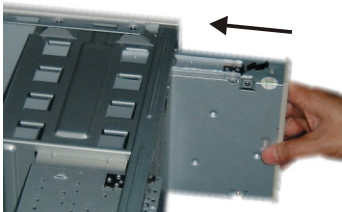

Slide CD-ROM in to 5.25" bay and Snap into place (Fig 14,15).

Fig. 15



## STEP 6. INSTALL 3.5" FDD,HDD

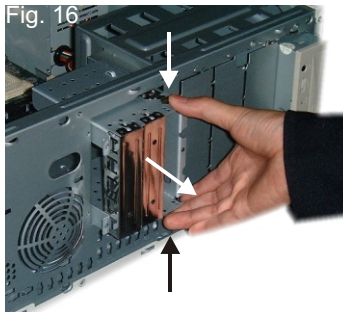

Squeeze tabs on sides 3.5" drive cassette and pull out to remove.(Fig.16)

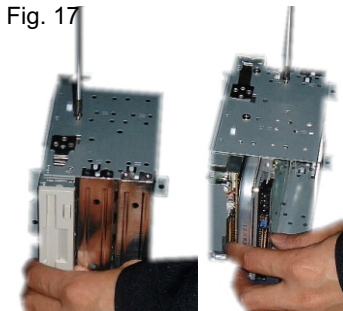

Slide floppy into the same cassette and fasten with fine thread flat head screws. (Fig.17 left)

Slide HDD into cassette and fasten with coarse thread flat head screws. (Fig.17 right)

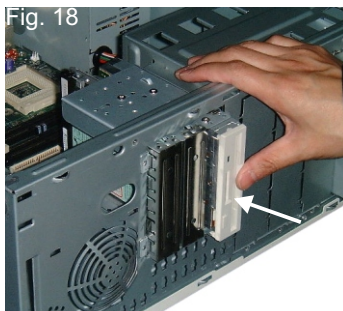

Reinstall 3.5" drive cassette (Fig.18)

## STEP 7. INSTALL FAN

Fig. 19

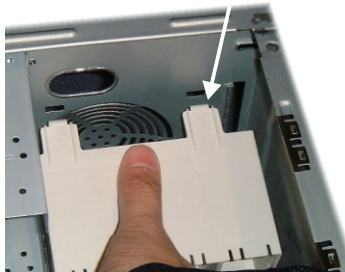

Remove fan housing by using thumbs to unfasten clips and place fan in housing (Fig 19).

Fig. 20

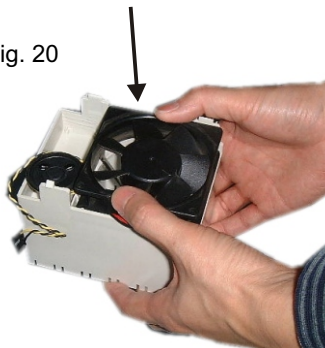

Push the fan with z click sound.(Fig 20)

Fig. 21

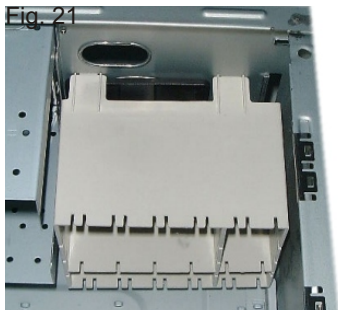

Snap fan housing back into the chassis. (Fig 21)

## STEP 8.

PLEASE CHECK ALL PROCEDURES ARE PROPERLY COMPLETED STEP BY STEP BEFORE PROCEED THE STEP 9

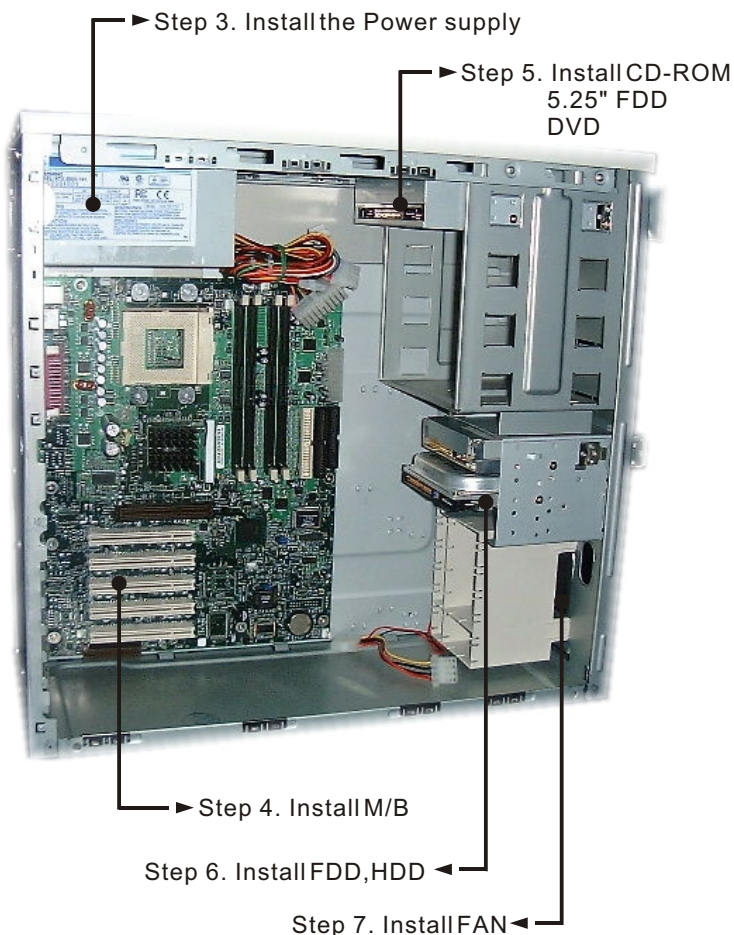

**STEP 9. REINSTALL LEFT SIDE PANEL**  
**STEP 10. REINSTALL FRONT BEZEL**



# PARTS LIST

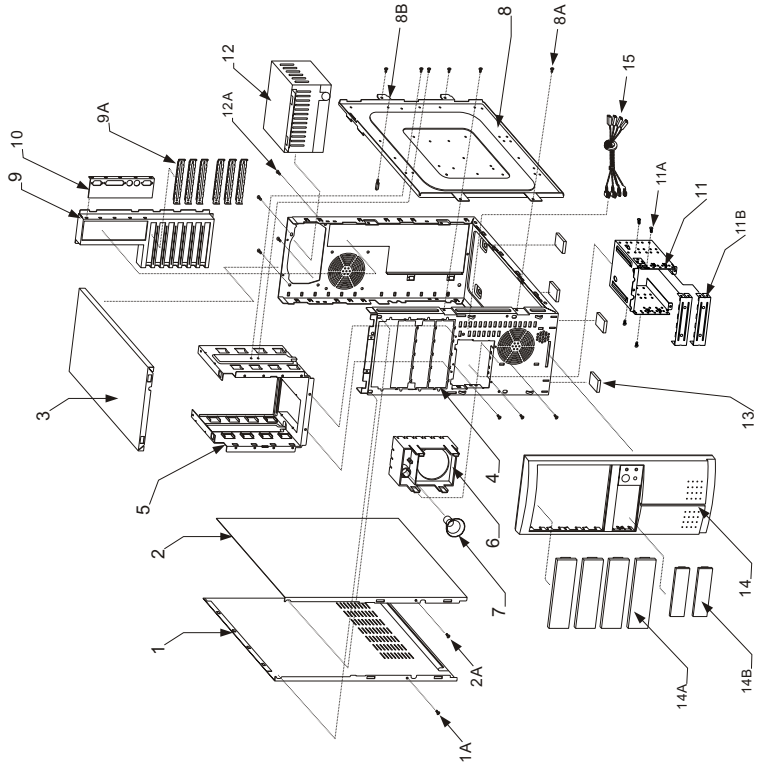

ITEM	PART NAME	Q'TY
1	LEFT SIDE PANEL	1
1A	SCREW #6-32.HEX	1
2	RIGHT SIDE PANEL	1
2A	SCREW #6-32.HEX	1
3	TOP COVER	1
4	CHASSIS BOSS	1
5	5.25" DRIVE BRACKET	1
6	CARD GUIDE BRACKET / FAN HOUSING HOLDER	1
7	SPEAKER	1
8	M/B BRACKET / MOUNTING PLATE	1
8A	SCREW #6-32*5 PHILLIPS	6
8B	STAND-OFF #6-32*10	14
9	ADAPTER BRACKET	1
9A	ADAPTER PLATE	1
10	I/O SHIELD A'SSY	1
11	3.5" DRIVE BRACKET SUB ASSY	1
11A	SCREW M3*5 PHILLIPS	4
11B	3.5" DRIVE SHIELD	2
12	SWITCH POWER SUPPLY	1
12A	SCREW #6-32*6 HEX*4 FOR P/S	4
13	RUBBER PAD	4
14	BEZEL ASSY	1
14A	5.25" DRIVE COVER	4
14B	3.5" DRIVE COVER	2
15	WIRES ASSY	1