



ABIT Home Theater SP-50 Speaker System

User's Guide

Safety

Read all warnings first! (Important Safety Precautions)

Damage Requiring Service. Unplug this product from the wall outlet and refer servicing to qualified service personnel under the following conditions:

- The power-supply cord or the plug has been damaged; or
- Objects have fallen onto, or liquid has been spilled into, the product; or
- The product has been exposed to rain or water; or
- The product does not operate normally when following the operating instructions. Adjust only those controls that are covered by the operating instructions, as an improper adjustment of other controls may result in damage and will often require extensive work by a qualified technician to restore the product to its normal operation; or
- The product has been dropped or damaged in any way; or
- The product exhibits a distinct change in performance - this indicates a need for service.

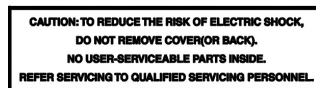

Caution

To maintain the high performance and reliability of this unit, avoid using or storing it in the following conditions.

- Dusty places.
- High humidity area such as the bathroom.
- Near heat sources such as stoves, etc.
- Places exposed to direct sunlight especially in a closed car.
- Extremely cold places.



Caution

- Do not place computer monitors, floppy disks, hard drives, or other 15 cm (6") of the subwoofer module. The magnetic field produced by this subwoofer module can erase magnetic media and interfere with the monitor.
- Before connecting the power plug of power cord to the wall outlet, make sure that your local power line AC voltage matches AC power input voltage as shown on the rear panel of subwoofer module
- When not planning to use this unit for long periods of time (i.e., vacation, etc.), disconnect the AC power plug from the wall outlet.
- This product should be operated only from the type of power source indicated on the marking label.
- To reduce the risk of fire or electric shock, do not expose this apparatus to rain or moisture.

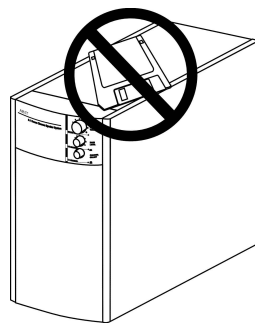

IMPORTANT SAFETY INSTRUCTION

1. Read these instructions.
2. Keep these instructions.
3. Read all warnings.
4. Follow all instructions.
5. Do not use this apparatus near water.
6. Clean only with a damp cloth.
7. Do not block any of the ventilation openings. Install in accordance with the manufacturer's instructions.
8. Do not defeat the safety purpose of the polarized-type plug. A polarized plug has two blades with one wider than the other. The wide blade is provided for your safety. When the provided plug does not fit into your outlet, consult an electrician for replacement of the obsolete outlet.
9. Do not install near any heat resource such as radiators, heat registers, stoves, or other apparatus (including amplifiers) that produce heat.
10. Protect the power cord from being walked on or pinched particularly at plug, convenience receptacles, and the point where they exit from the apparatus.
11. Only use attachments/accessories specified by the manufacturer.
12. Use only with a cart, stand, tripod, bracket, or table specified by the manufacturer, or sold with the apparatus. When a cart is used, use caution when moving the cart/apparatus combination to avoid injury from tip-over.
13. Unplug this apparatus during lighting storms or when unused for long period of time.
14. Refer all servicing to qualified service personnel. Servicing is required when the apparatus has been damaged in any way, such as power supply cord or plug is damaged, liquid has been spilled or objects have fallen into the apparatus, the apparatus has been exposed to rain or moisture, does not operate normally, or has been dropped.

Caution: These servicing instructions are not for use by qualified personnel only. To reduce the risk of electric shock do not perform any servicing other than contained in the operating instructions unless you are qualified to do so. Refer all servicing to qualified service personnel.

Warning: To reduce the risk of fire or electric shock, do not expose this apparatus to rain or moisture. The apparatus shall not be exposed to dripping or splashing and that no objects filled with liquids, such as vases, shall be placed on the apparatus.

ABIT Home Theater SP-50 System

CONTENTS

OVERVIEW	3
SPECIFICATIONS	4
PACKAGE CONTENTS	5
INSTALLATION INSTRUCTIONS	6
TROUBLESHOOTING	8
WARRANTY INFORMATION	10
GLOSSARY	11

OVERVIEW

Thanks for purchasing the ABIT Home Theater SP-50 system. The ABIT Home Theater SP-50 is a versatile audio entertainment system that supports DVD, VCD, and Game Sound for movie theater sound quality.

The ABIT Home Theater SP-50 features our revolutionary 5.1 Metal Speaker technology that provides over 30 percent audio clarity and output power than traditional speakers that come bundled with your PC system or Boom Box. You get five 10-Watt (RMS) 5.1 Metal Speakers (center/front Left/Right and Rear Left/Right Surround). The 35-Watt Subwoofer adds thundering deep bass sound and performance.

The ABIT Home Theater AU10 5.1channels sound card allows you to connect and convert virtually any audio input source such as; CD-ROM or DVD-ROM into a dynamic multimedia theater center. Installation guide will help you for easy navigation. With the ABIT Home Theater AU10, you can experience the same sound quality as that in Movie Theater -- true Dolby Digital sound effects with 5.1 separate soundtracks – right in your living room!

ABIT Home Theater SP-50 Speaker System:

SPECIFICATIONS:

Satellite Speaker: 10Watt (RMS) each

Dimensions: 80(W) x 105(H) x 84(D) mm

Impedance: 4 ohm

Center Speaker: 10Watt (RMS)

Dimensions: 165(W) x 90(H) x 125(D) mm

Impedance: 4 ohm

Subwoofer: 40Watt (RMS)

Dimensions: 206(W) x 380(H) x 510(D) mm

Impedance: 8 ohm x 2

Drivers:

Subwoofer: paper cone 6.5" x 2, 8 ohm, magnetic shielding

Satellite: 2" x 4, 4 ohm, magnetic shielding

Center: 2.4" x 5", 4 ohm magnetic shielding

Electrical rating:

↳ Continuous power

(1) 35W x1 ref. Subwoofer driven only at 100 Hz @ 1% THD

(2) 10W x 5 + 35 x 1 ref. All channels driven at 1% THD.

↳ Channel separation: >60dB ref. 1KHz

↳ Signal to Noise ratio: Subwoofer :>70dB @ 1W/A-wtd,

Satellite:>70dB @ 1W/A-wtd.

↳ Frequency response: Satellite 200Hz ~ 20KHz, Center 100Hz

~20KHz, Subwoofer 30Hz ~ 300Hz

↳ THD: <1% for all channels

↳ Power supply: 230V/50Hz, 120V/60Hz, 100V/50~60Hz

Main Components of ABIT Home Theater SP-50 System



PACKAGE CONTENTS:

Wooden Subwoofer	x1
Satellite speaker (R, L, SR, SL)	x1
Satellite speaker (C)	x1
Satellite Pads.....	x4
Center Pad.....	x1
Copper feet.....	x4
Power Cord	x1
Center Speaker Cable (4M)	x1
Front L/R Satellite Speaker Cable (6M)	x2
Surround L/R Satellite Speaker Cable (10M)	x2
G9 (DIN) cable (2M).....	x1
RCA plug 2ch / RCA plug 2ch (3M)	x1
User's Manual	x1

INSTALLATION INSTRUCTIONS

1. Power off the Computer or Electrical Device that you plan to connect to the ABIT Home Theater SP-50 system.
2. Carefully remove the ABIT Home Theater SP-50 system components from their packaging.
3. Place the Subwoofer on a flat, stable surface, preferably on the floor, apart from the walls, allowing a space of at least 10 cm above, behind and on the both sides of the unit. Please refer to System Layout figure for appropriate location.
4. Connect the G9 (DIN) cable to the **AUI0** (Nine Pin Outputs) connector located on the lower left of the **AUI0**. Connect the other end to the Subwoofer (G9 DECODER IN) connector.
5. Decide where you will position your Satellite speakers, preferably place the Satellite (L, R, C, SL, SR) on a flat, stable surface, or hang it on the wall. Please refer to System layout figure for appropriate location.
6. Connect Satellite(C) to Subwoofer RCA jack(C).
Connect Satellite (L) to Subwoofer RCA jack (L).
Connect Satellite (R) to Subwoofer RCA jack(R).
Connect Satellite (SL) to Subwoofer RCA jack (SL).
Connect Satellite (SR) to Subwoofer RCA jack (SR).
7. Plug-in Power Cord to the Subwoofer (Power Input).
8. Turn on the power to your PC and Subwoofer (located on the rear panel of the subwoofer). Adjust the Subwoofer and Volume Control knobs on the Subwoofer and enjoy theater quality sound with your new **ABIT Home Theater 5.1 System**.

Note

- a. Be sure not to tangle the Power-supply cord with the Sound source cable, thus to prevent the sound signal from being interfered by the power current.
- b. Be sure to turn the volume control counterclockwise before starting to play the audio source; increase the volume gradually to an appropriate level after the playback has started.

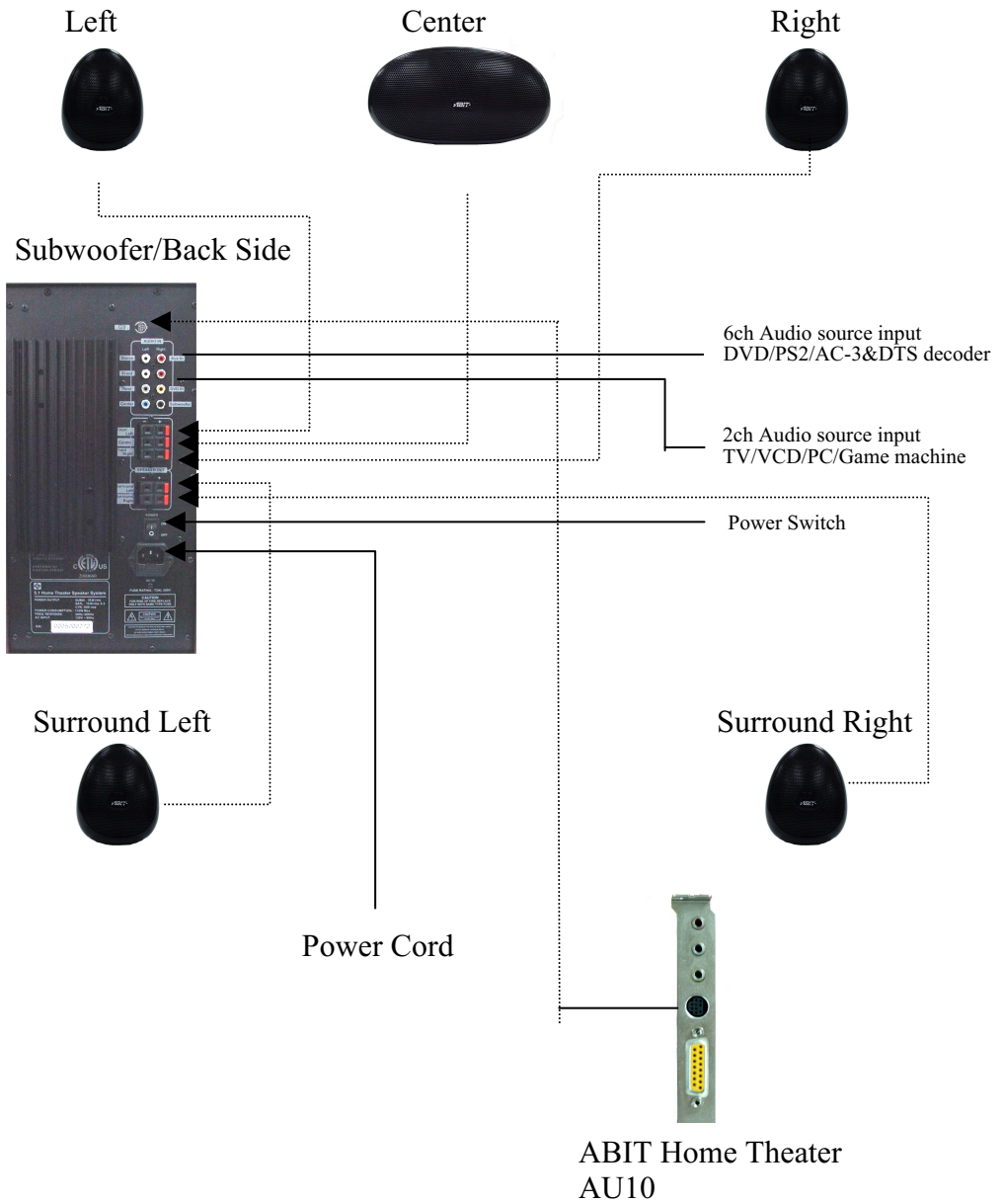

TROUBLESHOOTING AND SUPPORT

This appendix describes basic troubleshooting to help you solving problems, which you may have with the ABIT Home Theater system. Care and cleaning information, as well as Technical Support information are also provided.

Troubleshooting Problems

This section lists common questions and answers to installation and connection problems you may experience with the ABIT Home Theater system. If applying these methods does not solve the problem, contact Technical Support for further assistance.

Problem	Cause	Remedy
No Sound	Speaker not properly connected	Check cables for shorts or open connections
	With incorrect input mode	Select proper audio source (Digital or Analog)
	Amplifier is off/malfunction	Check your amplifier
	Speaker defective	Replace speaker
Weak sound	Volume control down	Turn up volume control
	Speaker cable shorted or have broken strands	Check cables
Buzzing sound	Speaker cable (wire) short	Check cable wiring
	Speaker defective	Replace speaker
No balance control	Check balance control setting	Adjust balance control
Excessive Highs or lows	Speaker out of circuit	Check speaker
Speaker test	Run the self test routing	Listen for white noise in all speakers

Note: These tests assume the amplifier is working correctly.

Speaker Placement:

The best placement for hi-fi speakers is not in the corners of the room. It is best to consider the listening room as an extension of the speaker enclosure. You may experience full rich sound from audio signal reflecting off other surface in the listening area as well as being radiated from the speaker itself. Feel free to experiment until you get the best sound. Do not be afraid to try something daring and different.

Room Consideration

The speakers may sound better in the Den or Office than in the living room. Such things as windows, drapes, carpeting and other surfaces, and the room dimension play an important part in the sound response.

Avoid placing speakers in the corner of the room. This greatly degrades the frequency response since sound bounces off three surfaces and produces heavy bass signal. It is best to place the speakers two to three feet from the wall. The attached diagram displays various positioning locations using a rule of placement 3,5,7,9.

EXAMPLE 12 feet / 3 = 4 feet.

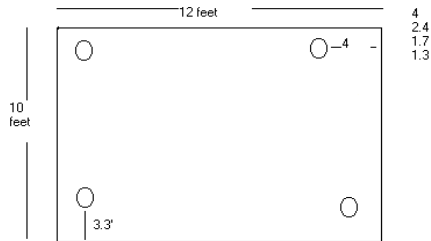

3.3 2 1.4 1.1

Placement position based upon a 10/12 room

WARRANTY INFORMATION

Your ABIT Home Theater SP-50 System comes with a one-year warranty from the date of purchase. This warranty does not cover any incompatibilities due to the user's computer, hardware, audio station or any other related system configuration in which the ABIT Home Theater System interfaces.

This warranty does not cover any damage caused by negligence, non-authorized modifications, or parts installed.

This warranty does not apply if the product has been damaged by accident, abuse, misuse, or misapplication, nor as a result of service to the product by anyone other than by manufacturer.

When you send in your product, ensure it is adequately cushioned to prevent damage during shipping. Include all hardware and software that came with your ABIT Home Theater system, so that the integrity of these pieces can also be verified by service center.

Note: *It is recommended that you ship your ABIT Home Theater system fully insured and freight pre-paid. It will not be accepted if product damaged and caused by poor handling and shipping.*

GLOSSARY

- **Dolby Digital (AC-3):**

Multi channel digital audio decoding system. Delivery of mono through 5.1-channel (left, center, right, subwoofer, surround left and right) at data rates from 32 kb/s to 640 kb/s, thus offering flexibility and economical performance as well as uncompromised sound quality.

- **Dolby Pro Logic:**

A matrix surround sound 4:2:4 matrix decoding scheme, consisting of left, center, right, and surround.

- **Decibel (dB):**

The unit commonly used to compare signal levels. Decibel is used as a measure of response in all types of electrical circuits, and is also used as a measure of sound level in audio systems (relative to a reference level).

- **Hertz:**

The unit of frequency named after the physicist Heinrich Hertz (1857-1894). 1 hertz (Hz) is equal to 1 cycle/second. Other units of frequency commonly encountered are the kilohertz (kHz) = 1,000 Hz and the megahertz (MHz) = 1,000,000 Hz.

- **Impedance:**

A complex reaction of resistance to AC in an electrical circuit.

- **MPEG-2:**

MPEG-2 is an expanded MPEG-1 specification with additional extensions for more digital and audio applications. It was targeted at high-speed all-digital transmission of broadcast quality video and supports a data transfer rate of 4 to 9 megabits/second. It is used in DVD players for maximum compression of video and audio.

- **Ohm:**

Unit of measure for resistance in an electrical circuit.

- **RMS:**

Root Mean Square. A way of measuring average power levels.

- **Watt (W):**

The basic unit of power. In audio systems, the output power of a stereo amplifier is rated in watts per channel, e.g. 2 x 30 W.